

EuroFit Fabric Hanging Banners Displays - Round

210150, 210151, 210152, 210154, 210155, 210156, 210158, 210159, 210160, 210162, 210163, 210164

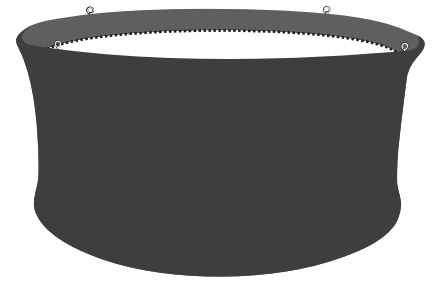

*Artwork Templates Available

INSTRUCTION DRAWINGS SHOW 6FT DISPLAY.

Product Parts (6FT HARDWARE SHOWN)

QTY for other frames in STEP 1.

- 1 - Top Frame Bars (x4)*
- 2 - Bottom Frame Bars (x4)*
- 3 - Vertical Bars (x4)*
- 4 - Bottom Screws (x4)*
- 5 - Top Screws w/ Loop (x4)*
- 6 - Hanging Cables (4 attached)*
- 7 - Hanging Clips (4)*
- 8 - Ceiling Clips*

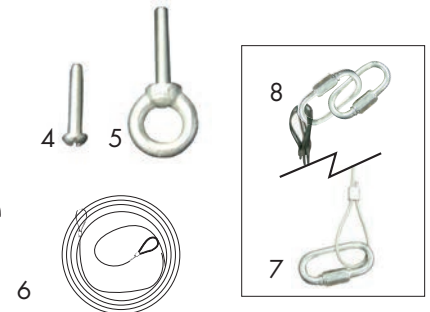
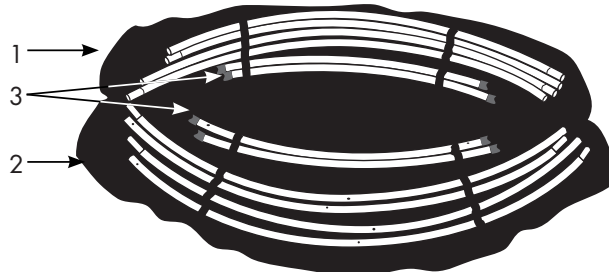

Display Set-Up

Step 1

Take all parts out of the bag.

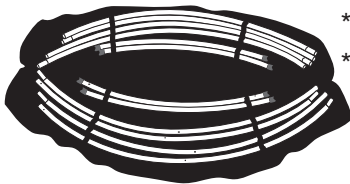

Frame	Parts QTY
6' Round	(x4) as shown
8' Round	(x5)
10' Round	(x6)
12' Round	(x7)

Step 2

All Frame pieces should be labeled. Lay the Top Frame Bars (1) in a circle in numerical order. Connect all the bars into a circle by placing the tapered end of the 1st bar into the large end of the next bar until the release button snaps into place.

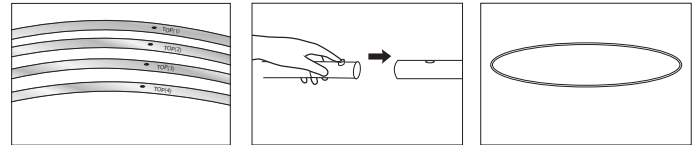

TOP CIRCLE (1a)

Step 3

Repeat this assembly with the Bottom Frame Bars (2).

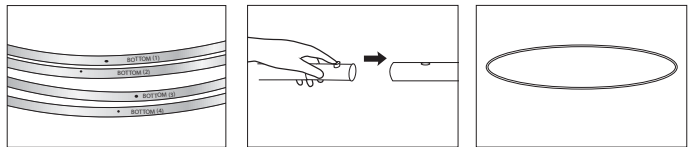

BOTTOM CIRCLE (2a)

Step 4

Place the assembled Bottom Circle (2a) on the floor with the release buttons facing up. Align each Vertical Bar (3) with the center holes of the Bottom Circle (2a). With the curve of the

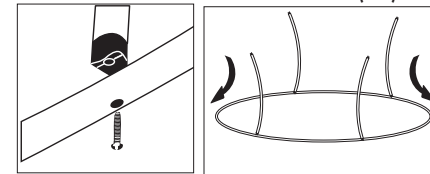

Vertical Bars towards the center, fasten them in place using the Bottom Screws (4).

Step 5

Place the assembled Top Circle (1a) on top to create unit. Place a few Top Screws w/ Loop (5) in to secure briefly.

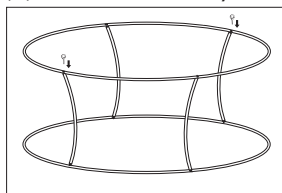

Step 6

Unzip your graphic and place the Bottom Circle (2a) within the graphic. NOTE: make sure printed side is facing out and graphic is facing up.

Locate the reinforced holes along the top edge of the Graphic, and line them up with each Vertical Bar (3).

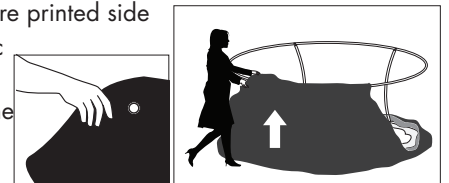

NOTE: WHEN POSITIONING FABRIC AROUND THE FRAME CAREFULLY LIFT AND REPOSITION-DRAGGING FABRIC CAN CAUSE SNAG.

Display Set-Up Continued...

Step 7

Secure the outside of the Fabric Graphic to Frame by feeding the Top Screws w/ Loop (5) into the hole from the Fabric Graphic and then through the hole in the Top Frame Bars (1). Tighten into the Top Circle (1a) at each of the Vertical Bar (3) locations.

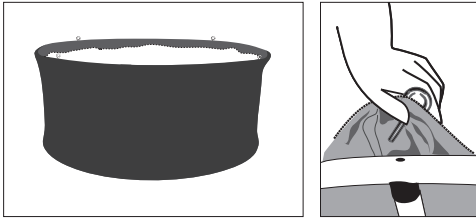

Step 8

Step inside the frame. With the outside of the Fabric Graphic now connected to the Frame, zipper together the inside of the Fabric Graphic to the outside of the Fabric Graphic.

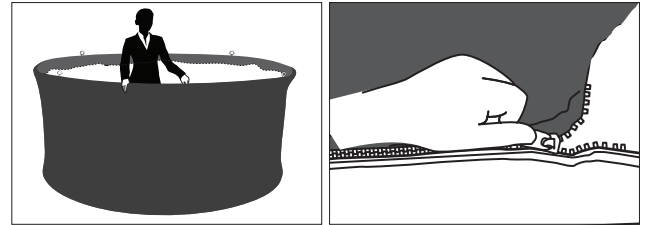

Step 9

Lay the Hanging Cables (6) in the center of the assembled display. Spread out the Frame Clip (7) ends of the Cables to prevent tangling and awkward hanging tension. Connect each Frame Fastener (7) to the Loops in the Top Screws (5). Attach the Ceiling Clips (8) to your hardware (not included).

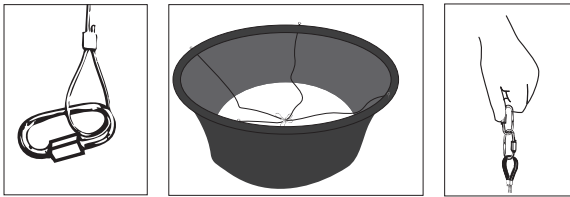

Storage

Place all product parts into Carry Case and store in a cool dry location.



Care

Recommended for indoor use only.

Machine wash on gentle cycle using mild detergent. Tumble dry on low heat setting only. Do Not dry Clean, Do Not iron.

Warranty Information: All products are designed to provide the user with a cost-effective and durable product. Standard warranty is a 'one year parts and labor' warranty which warrants product against defects in material and workmanship. It does not cover damage due to accidents, abuse, or normal wear and tear. Products found to be defective will be replaced or repaired at factory's discretion.